



**CERTIFIED SURVEY MAP**

PART OF THE SW 1/4 OF THE SW 1/4 OF SECTION 18, T.3N., R.14E. OF THE 4TH P.M., TOWN OF JOHNSTOWN, ROCK COUNTY, WISCONSIN.

**OWNER'S CERTIFICATE OF DEDICATION-DONALD S. & BARBARA D. MERRIAM REVOCABLE TRUST**

As owner, I hereby certify that I have caused the land described on this map to be surveyed, divided, mapped, and dedicated as represented hereon.

x Robert A. Merriam  
Robert A. Merriam, Trustee

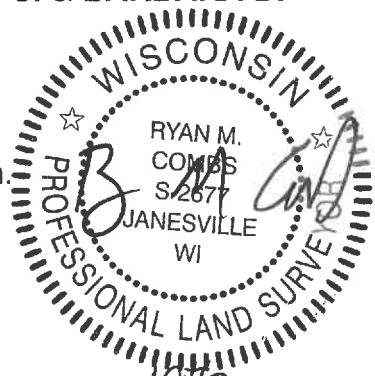

State of Wisconsin  
County of Rock SS. Personally, came before me this 19<sup>th</sup> day of September, 2022, Robert A. Merriam to me well known to be the person who executed the owner's certificate hereon shown and acknowledged the same.

Notary Public, Winnebago County, Wisconsin [Signature]

My Commission 11/29/2022

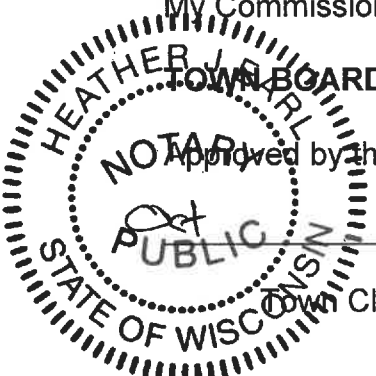

**TOWN BOARD APPROVAL**

Approved by the Board of the Town of Johnstown this 1<sup>st</sup> day of October, 2022.  
Town Clerk \_\_\_\_\_



**CITY OF JANESVILLE APPROVAL**

Approved by the City Plan Commission this 3 day of October, 2022.  
Secretary [Signature]

**CERTIFIED SURVEY MAP**

PART OF THE SW 1/4 OF THE SW 1/4 OF SECTION 18, T.3N., R.14E. OF THE 4TH P.M., TOWN OF JOHNSTOWN, ROCK COUNTY, WISCONSIN.

**ROCK COUNTY TREASURER'S CERTIFICATE**

I hereby certify that the Property Taxes on the parent parcel are current and have been paid as of \_\_\_\_\_, 20\_\_\_\_\_.

Rock County Treasurer \_\_\_\_\_

**ROCK COUNTY PLANNING AND DEVELOPMENT**

This Final Land Division No. \_\_\_\_\_ is approved, this \_\_\_\_\_ day of \_\_\_\_\_, 20\_\_\_\_\_.

Secretary \_\_\_\_\_

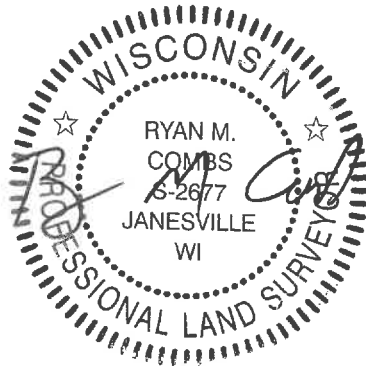

SHEET THREE OF FOUR SHEETS  
Project No. 122-280 For: MERRIAM

**COMBS & ASSOCIATES, INC.-SURVEYING-MAPPING-PLANNING-JANESVILLE, WI**

**CERTIFIED SURVEY MAP**

PART OF THE SW 1/4 OF THE SW 1/4 OF SECTION 18, T.3N., R.14E. OF THE 4TH P.M., TOWN OF JOHNSTOWN, ROCK COUNTY, WISCONSIN.

**SURVEYOR'S CERTIFICATE**

State of Wisconsin

County of Rock

SS. I, Ryan M. Combs, a Professional Land

Surveyor No. 2677, do hereby certify that I have surveyed, divided, and mapped

PART OF THE SW 1/4 OF THE SW 1/4 OF SECTION 18, T.3N., R.14E. OF THE 4TH P.M., TOWN OF JOHNSTOWN, ROCK COUNTY, WISCONSIN.

DESCRIBED AS FOLLOWS: Beginning at an aluminum monument at the SW Corner of said Section; thence N0°51'19"W along the West Line of the SW 1/4 of said Section, 725.0 feet; thence S88°15'36"E 436.77 feet; thence S0°51'19"E 725.0 feet to the South Line of the SW 1/4 of said Section; thence N88°15'36"W along said South Line, 436.77 feet to the place of beginning. Containing 7.26 Acres. That such map is a correct representation of all exterior boundaries of the land surveyed and the division of that land. That I have made such survey, division, and map by the direction of Robert A. Merriam and that I have fully complied with the provisions of Chapter 236.34 of the Wisconsin Statutes in surveying, dividing, and mapping the same.

Given under my hand and seal this 1st day of September, 2022, at Janesville, Wisconsin.

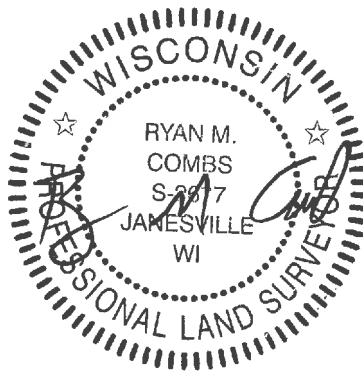

**RECORDING DATA**

No. \_\_\_\_\_ received for record this \_\_\_\_\_ day of \_\_\_\_\_, 20\_\_\_\_, at \_\_\_\_\_ o'clock \_\_\_\_M., and recorded as \_\_\_\_\_,

of Certified Survey Maps of Rock County, Wisconsin.

Register of Deeds \_\_\_\_\_

SHEET FOUR OF FOUR SHEETS  
Project No. 122-280 For: MERRIAM

**COMBS & ASSOCIATES, INC.-SURVEYING-MAPPING-PLANNING-JANESVILLE, WI**